

Section 4

Basic Bracing

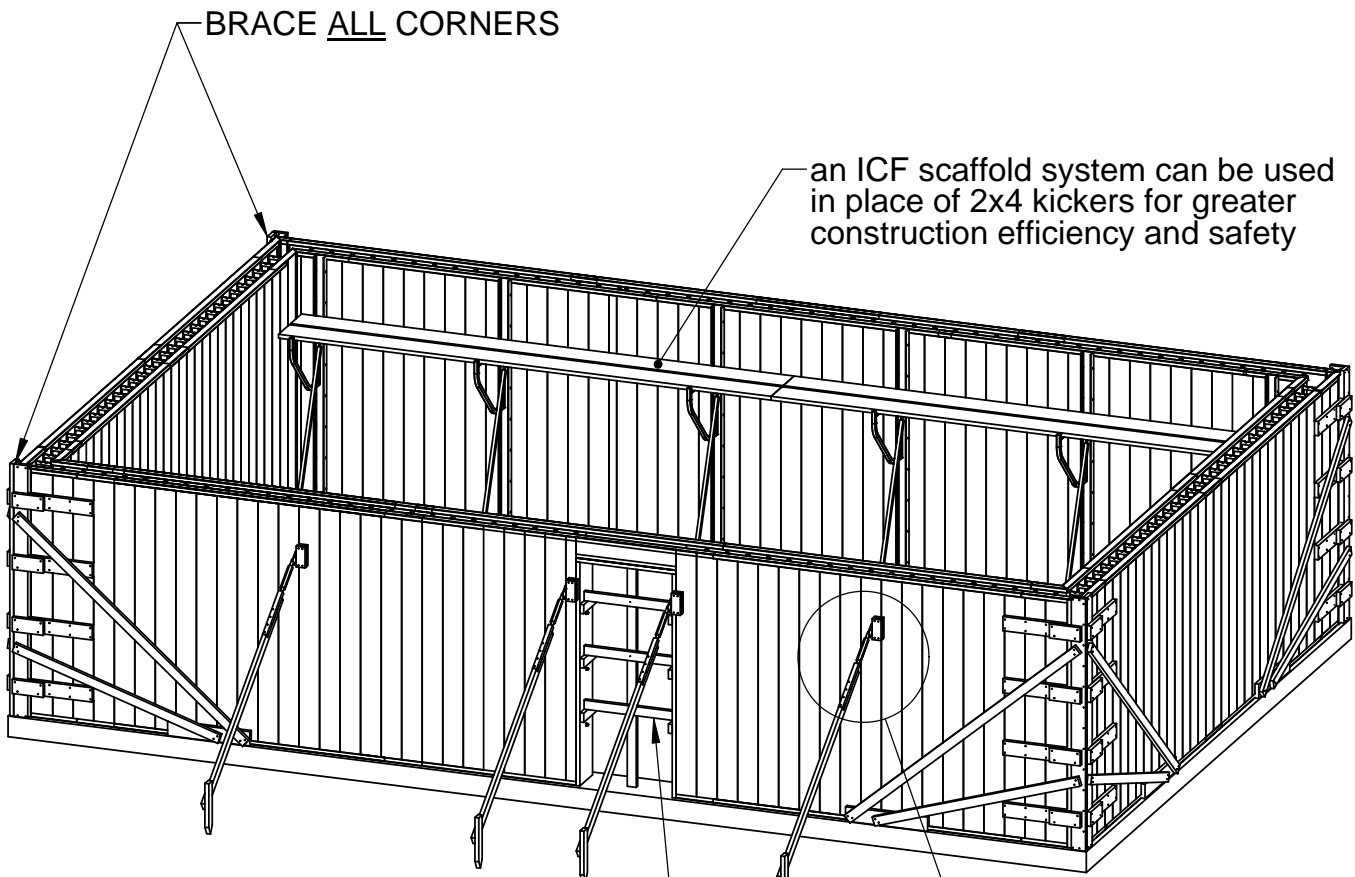

BRACE ALL CORNERS

an ICF scaffold system can be used in place of 2x4 kickers for greater construction efficiency and safety

Brace one side of each wall as needed to keep wall plumb and straight. Turnbuckles make the process easier.

brace all openings vertically and horizontally

2x4 with Symons™ Turnbuckle



Typical Bracing Overview

TF System®
800-360-4634
www.TFSystem.com

Date: 12/2/2009

Page Number: 45

Use two screws at all connection points

Make certain the corner form is tight into the corner brace

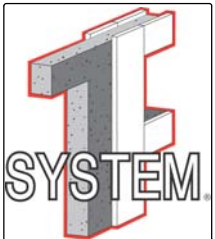
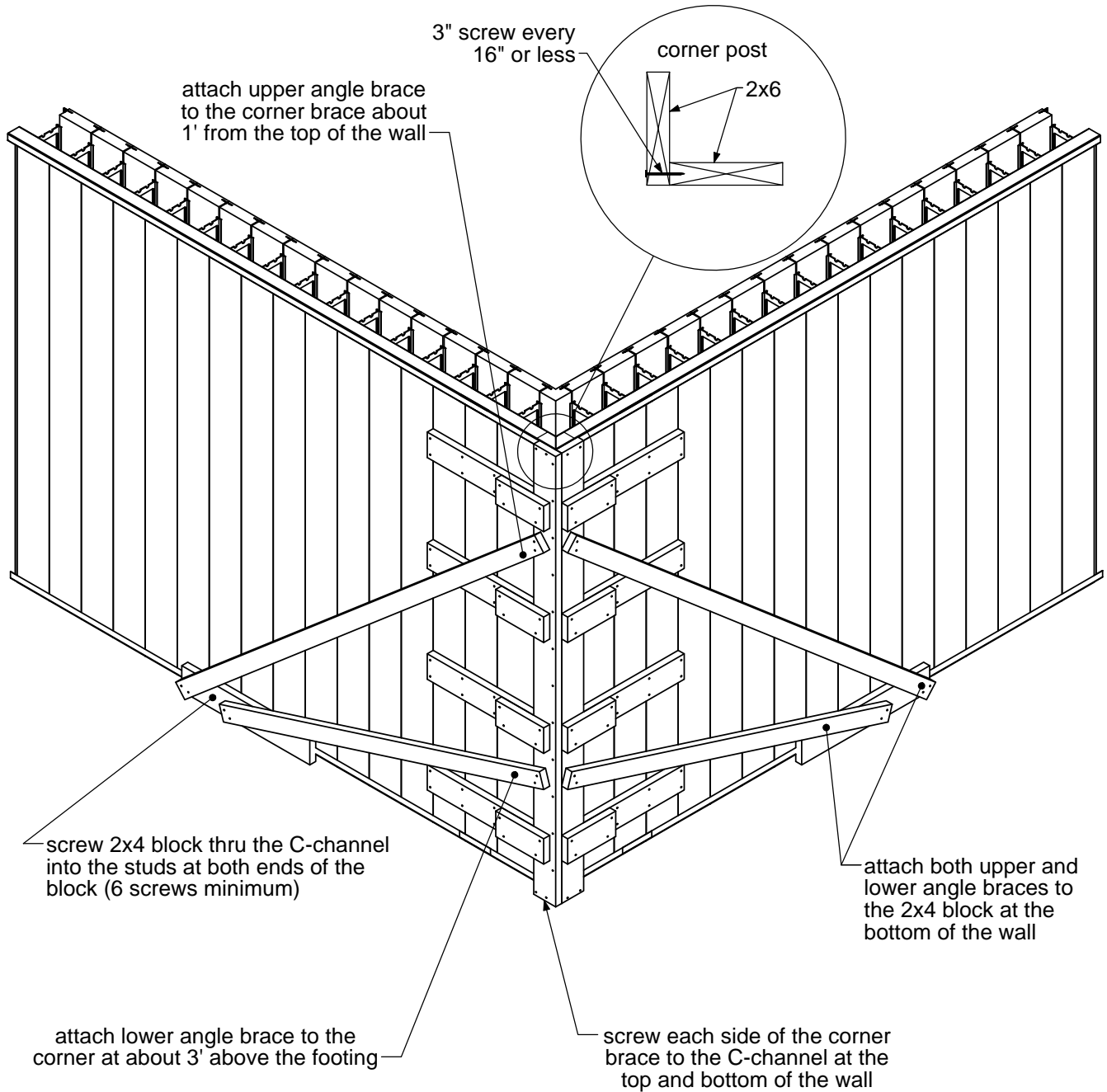

Corner Bracing

9' High or Less

TF System®
800-360-4634
www.TFSystem.com

Date: 10/13/2009

Page Number: 46

Use two screws at all connection points

Make certain the corner form is tight into the corner brace

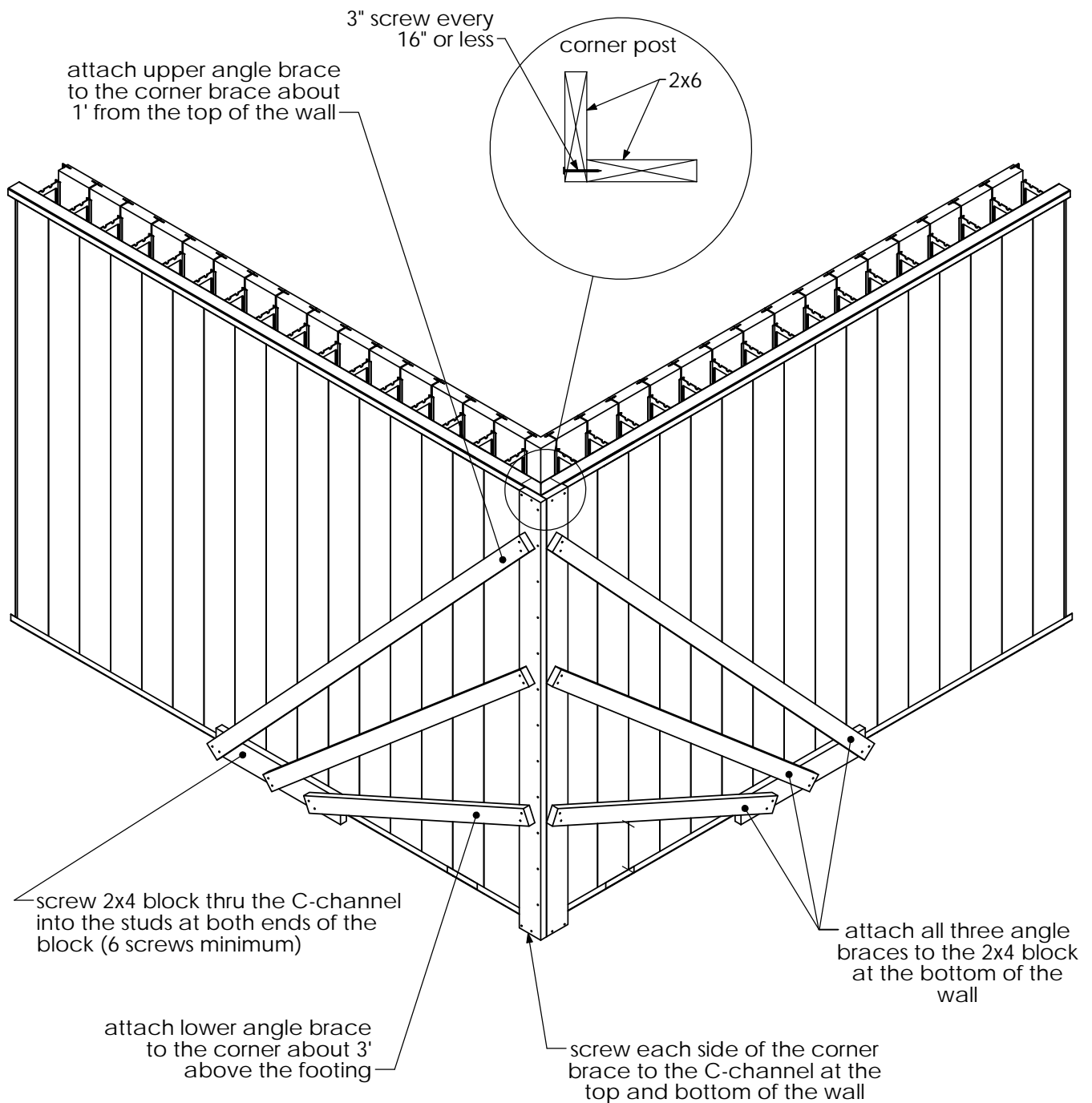

Corner Bracing

10' - 12' High

TF System®
800-360-4634
www.TFSystem.com

Date: 12/2/2009

Page Number: 47

Disclaimer: The following examples are guidelines on how to brace narrow windows and doors. Always seek advice from experienced professionals to determine the amount of bracing needed to support a particular header.

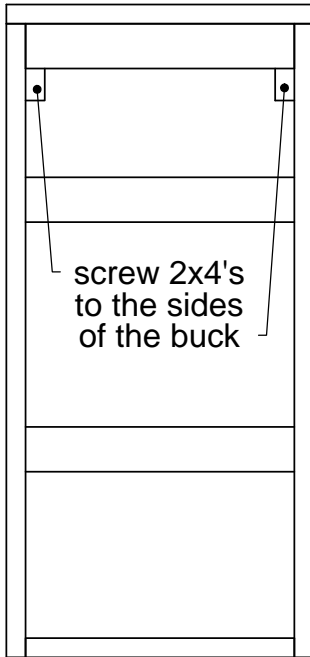

OR

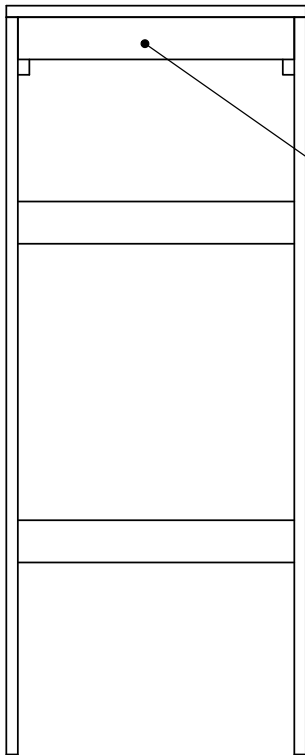
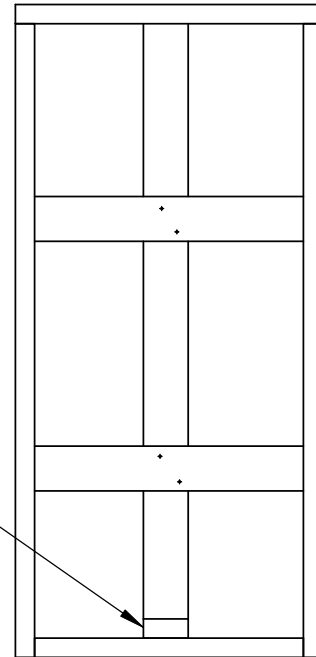

OR

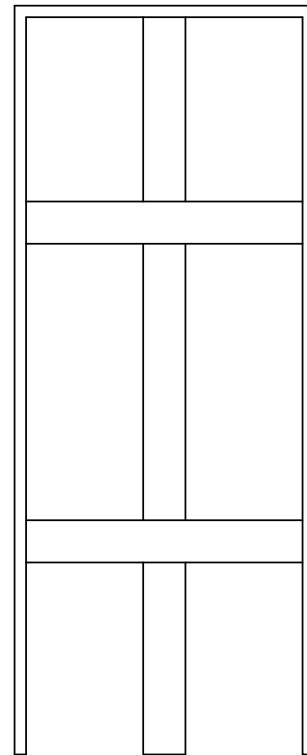

The amount of bracing needed to support a header is based on the span and height. Always seek advice from an experienced contractor or engineer. If in doubt, always use more bracing rather than less!

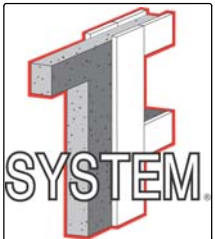

Window and Door Bracing

TF System®
800-360-4634
www.TFSystem.com

Date: 10/13/2009

Page Number: 48

attach 2x6 angle brace
(same as corner brace)
to back of T intersection
at least every 16"

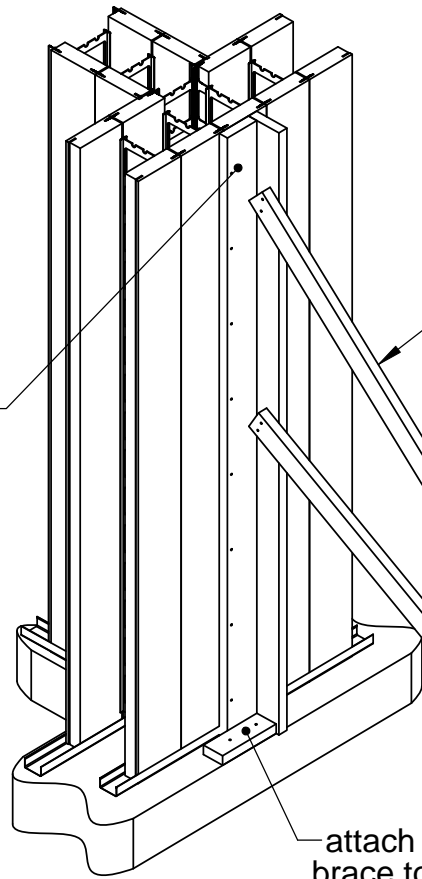

secure angle brace
with kickers at the
top and midpoint

attach bottom
brace to footing

be sure this
stake is firmly
anchored!

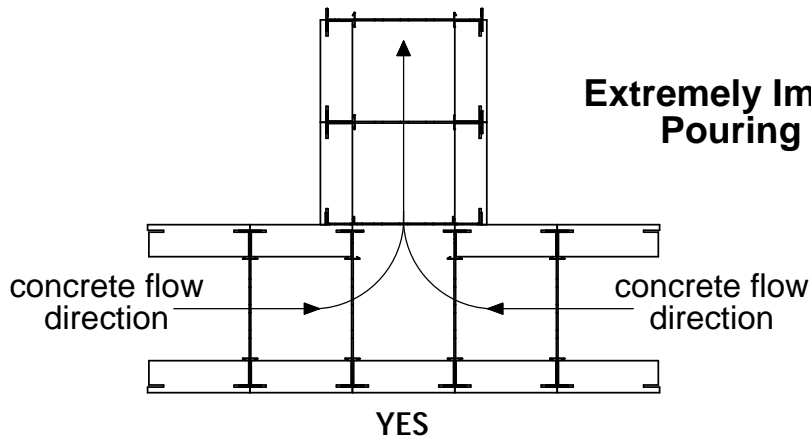

Extremely Important Pouring Tip

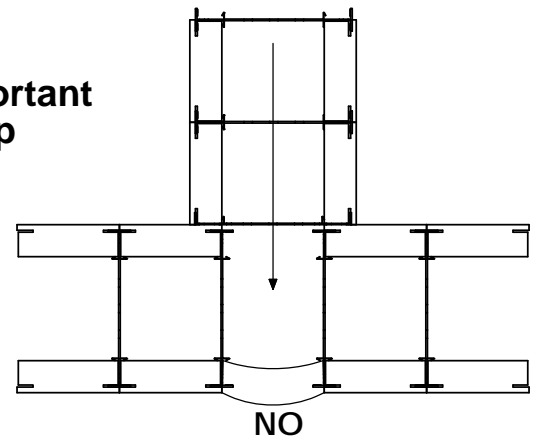

brace backside of T intersection plumb before attaching the T stud



T Intersection Bracing

TF System®
800-360-4634
www.TFSystem.com

Date: 11/25/2009

Page Number: 49

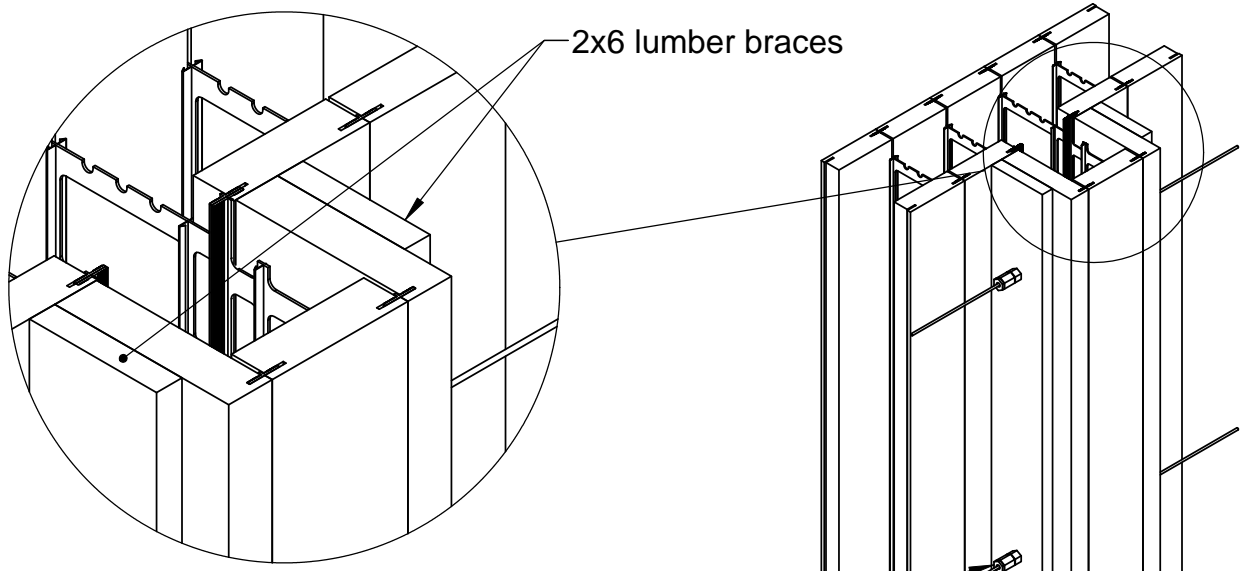

threaded rod or SuperTie™
 SuperTie is a registered trademark
 of RJD Industries Inc.

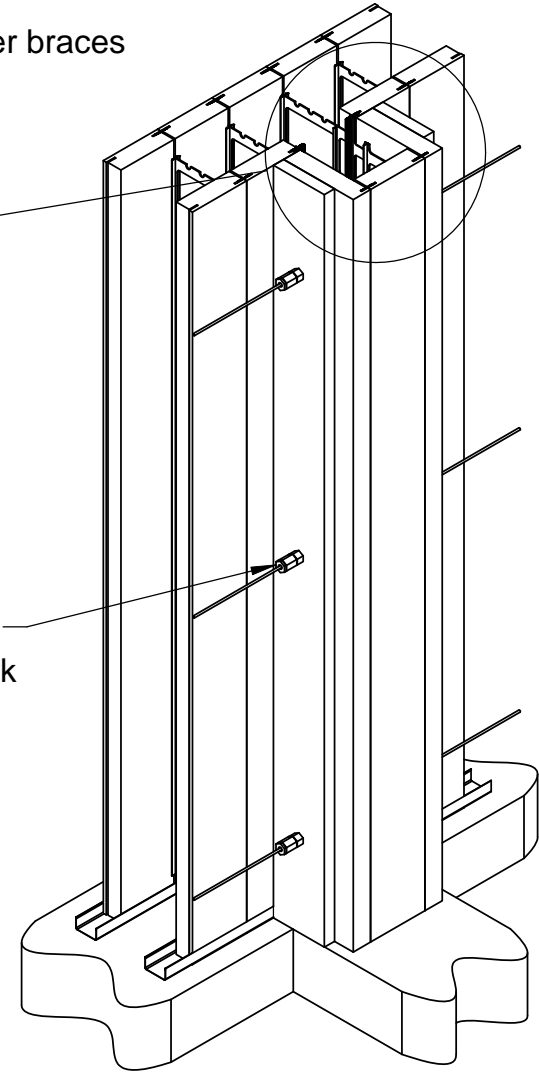

remove inner flanges from
 one side of these panels

groove face
 of poly panels

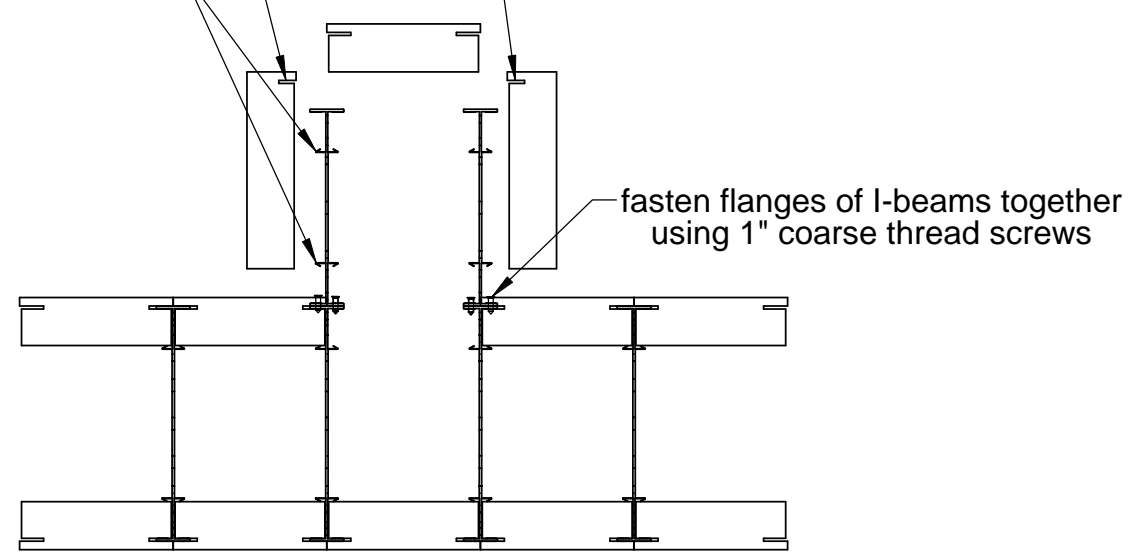

Pilaster Column

TF System®
 800-360-4634
 www.TFSystem.com

Date: 10/28/2009

Page Number: 50